

FOR PROFESSIONALS



installation instructions [en] Cladding for the Stûv 21 (V2)

April 2014

This cladding has been designed to ensure maximum convenience and safety. It has been manufactured with the greatest of care. If however you should find the slightest dissatisfaction with it, please contact your supplier.

We recommend that you read these instructions prior to installation.

Some configurations might have an impact on the sequence of operations to be performed.

Contents

| | |
|---|-----------|
| PRESENTATION OF THE PRODUCT | 3 |
| Dimensions | 3 |
| Recommandations | 5 |
| Overview | 5 |
| PREPARATION OF THE AREA | 7 |
| Insulating the fireplace: pros & cons | 7 |
| Tools | 7 |
| Placement du foyer | 7 |
| ASSEMBLY OF A FAÇADE | 8 |
| How to position the stove when installing a façade | 8 |
| Screws needed | 8 |
| Installation of a façade | 9 |
| ASSEMBLY OF A READY-TO-FIT CHIMNEY | 11 |
| Visserie de la devanture | 11 |
| Visserie de la partie corps | 11 |
| How is the stove positioned when installing a ready-to-fit chimney SF ? | 11 |
| Assembly of cladding | 12 |
| ASSEMBLY OF THE MOBILE LOG HOLDER | 17 |
| MAINTENANCE | 18 |
| CONTACTS | 19 |

PRESENTATION OF THE PRODUCT

Dimensions

SF2

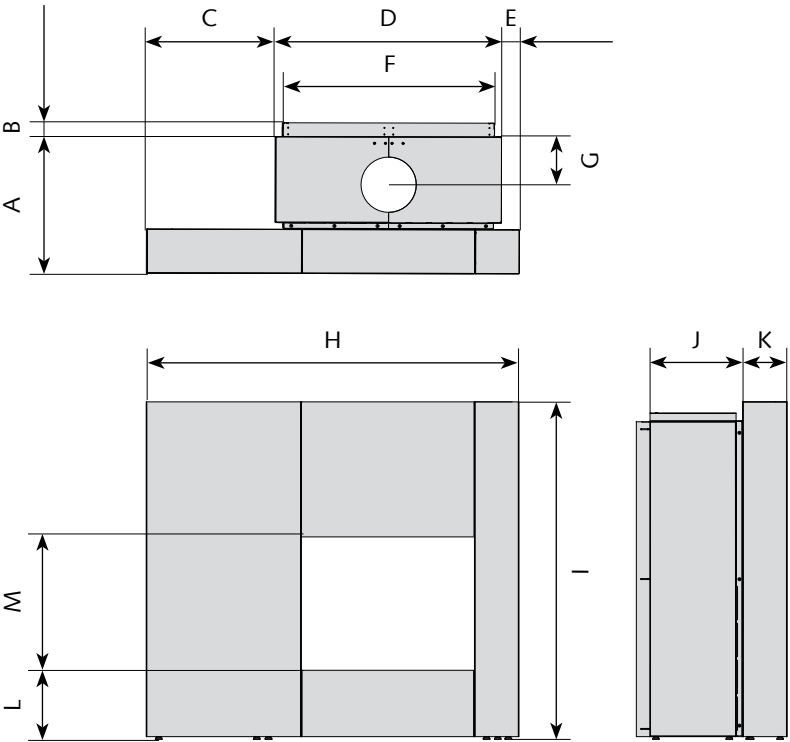

Flue to be installed SF

| | 21/75 | 21/85 | 21/95 | 21/105 |
|-----|---------------|---------------|---------------|---------------|
| A | 555 | 620 | 655 | 540 |
| B* | 0, 12, 42, 62 | 0, 12, 42, 62 | 0, 12, 42, 62 | 0, 12, 42, 62 |
| C | 582 | 582 | 582 | 582 |
| D | 920 | 1020 | 1120 | 1220 |
| E | 82 | 82 | 82 | 82 |
| F | 855 | 955 | 1055 | 1155 |
| G** | 215 | 215 | 215 | 215 |
| H | 1584 | 1685 | 1784 | 1884 |
| I | 1430 | 1530 | 1650 | 1325 |
| J | 355 | 420 | 455 | 340 |
| K | 200 | 200 | 200 | 200 |
| L | 300 | 300 | 300 | 300 |
| M | 524 | 603 | 683 | 469 |

SF1

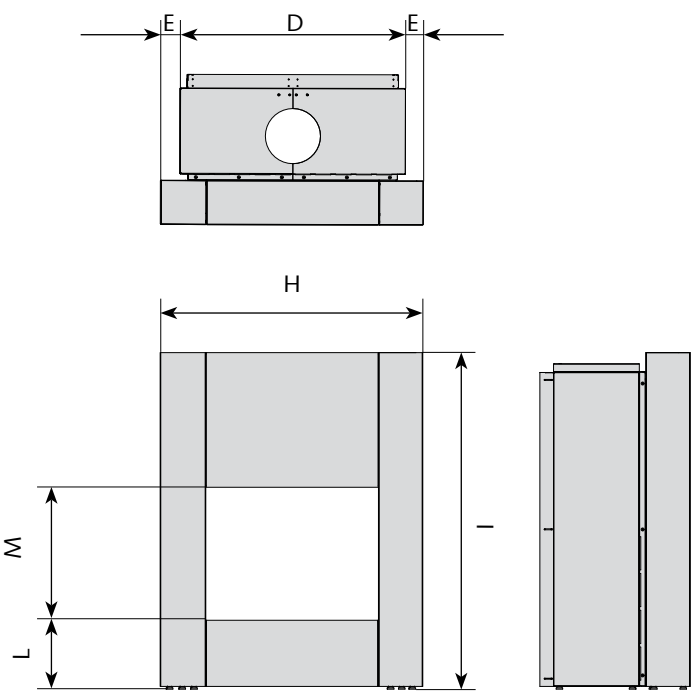

| | 21/75 | 21/85 | 21/95 |
|---|-------|-------|-------|
| E | 82 | 82 | 82 |
| D | 920 | 1020 | 1120 |
| H | 1084 | 1184 | 1284 |
| I | 1430 | 1530 | 1650 |
| L | 300 | 300 | 300 |
| M | 524 | 603 | 683 |

* The 4 measurements correspond to the 4 possible positions.
The measurement is determined by the nature of the insulation recommended in the legislation applicable.

** If necessary, add B to G to determine the space between the centre of the smoke outlet and the partition.

DF2

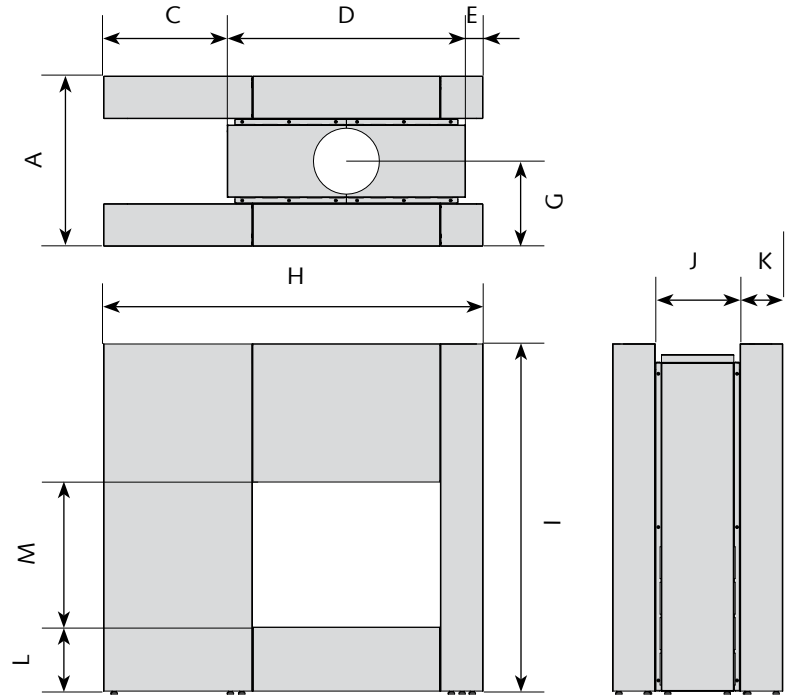

Flue to be installed DF

| | 21/75 | 21/85 | 21/95 |
|---|-------|-------|-------|
| A | 800 | 800 | 800 |
| C | 582 | 582 | 582 |
| D | 920 | 1020 | 1120 |
| E | 82 | 82 | 82 |
| G | 400 | 400 | 400 |
| H | 1584 | 1685 | 1784 |
| I | 1430 | 1530 | 1650 |
| J | 340 | 340 | 340 |
| K | 200 | 200 | 200 |
| L | 300 | 300 | 300 |
| M | 524 | 603 | 683 |

Recommendations

Read the installation instructions and directions for use before installation and actual usage.

Also adhere to your stove's directions for use.

We strongly recommend you entrust the installation of this Stûv cladding to a qualified professional.

Once the cladding has been installed, hand these instructions over to the user.

Signing the delivery forms signifies that you accept the product and acknowledge that the merchandise is compliant with the merchandise

ordered. It is therefore very important to check the integrity of the merchandise on delivery.

Adhere to the maintenance guidelines.

Any modification made to this cladding may create the risk of danger. Furthermore, it will also exempt it from the guarantee cover.

The installation of the stove, its accessories and surrounding materials must meet all regulations (local and national) and all standards (national and European).

Overview

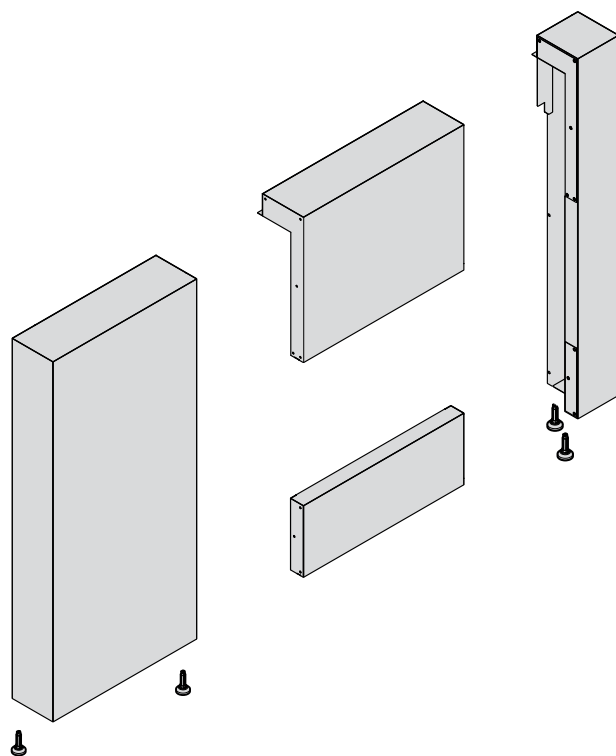

Front section

Flue to be installed SF

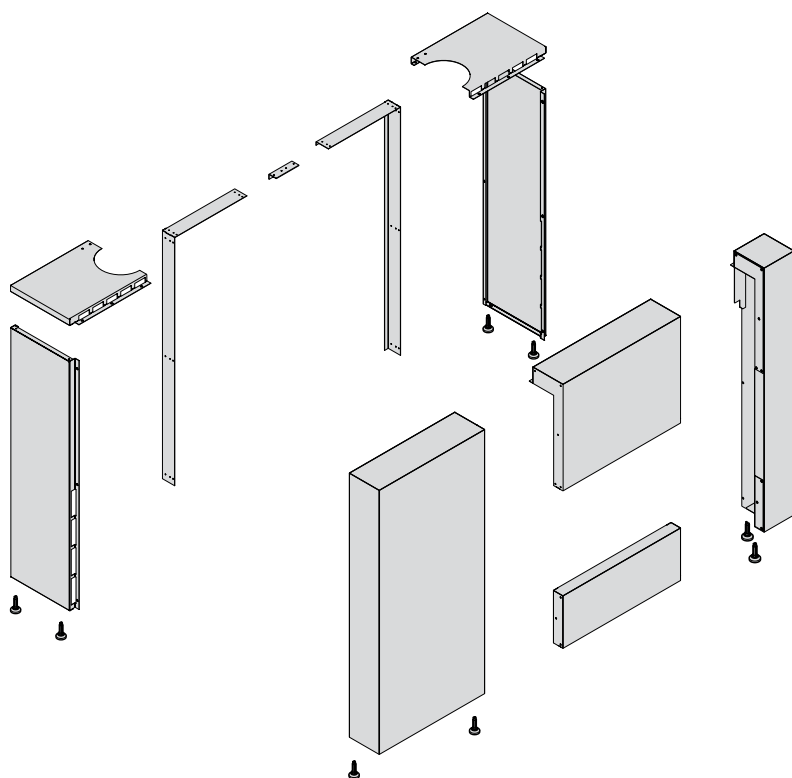

Flue to be installed DF

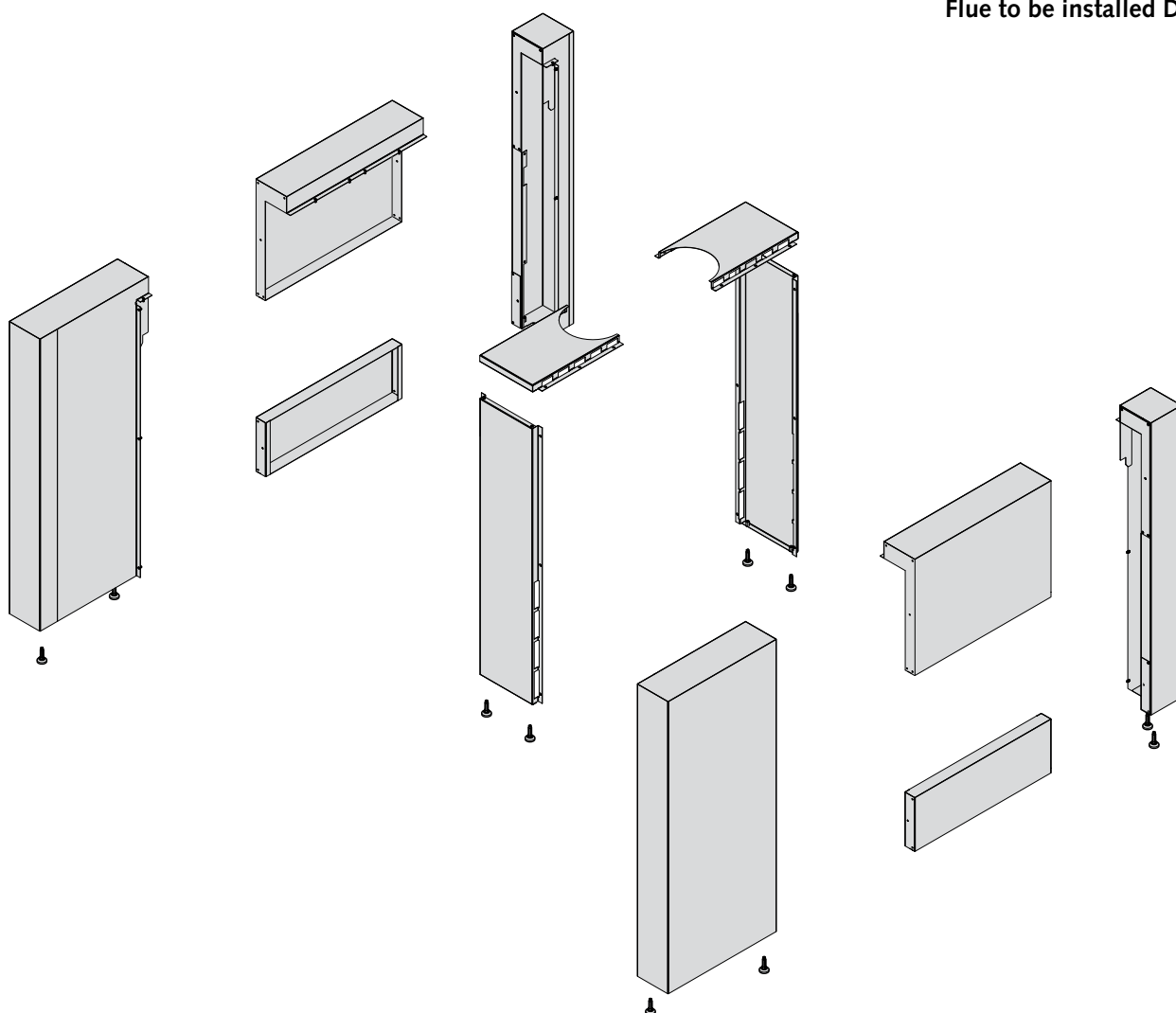

PREPARATION OF THE AREA

Insulating the fireplace: pros & cons

Safety

Take the necessary precautions to prevent excessive heating of the recess walls and construction materials close to the stove (e.g. wooden beams) and insulate these materials according to industry regulations and the applicable standards depending on their flammability.

Tools

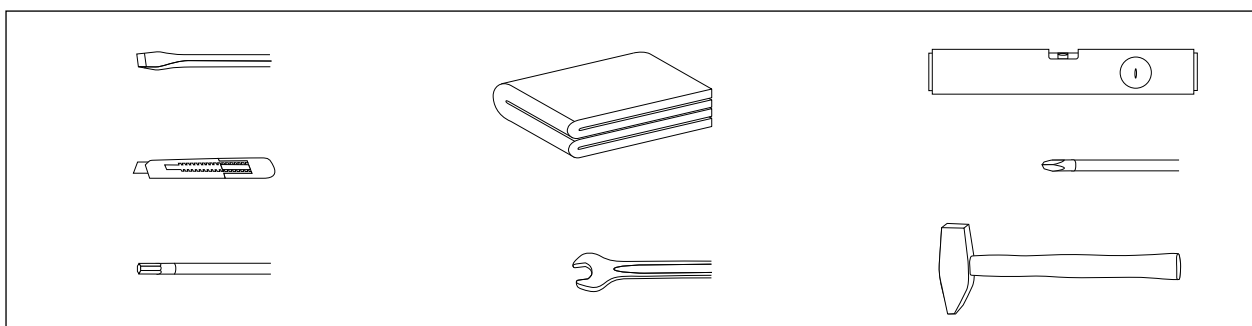

Positioning the stove

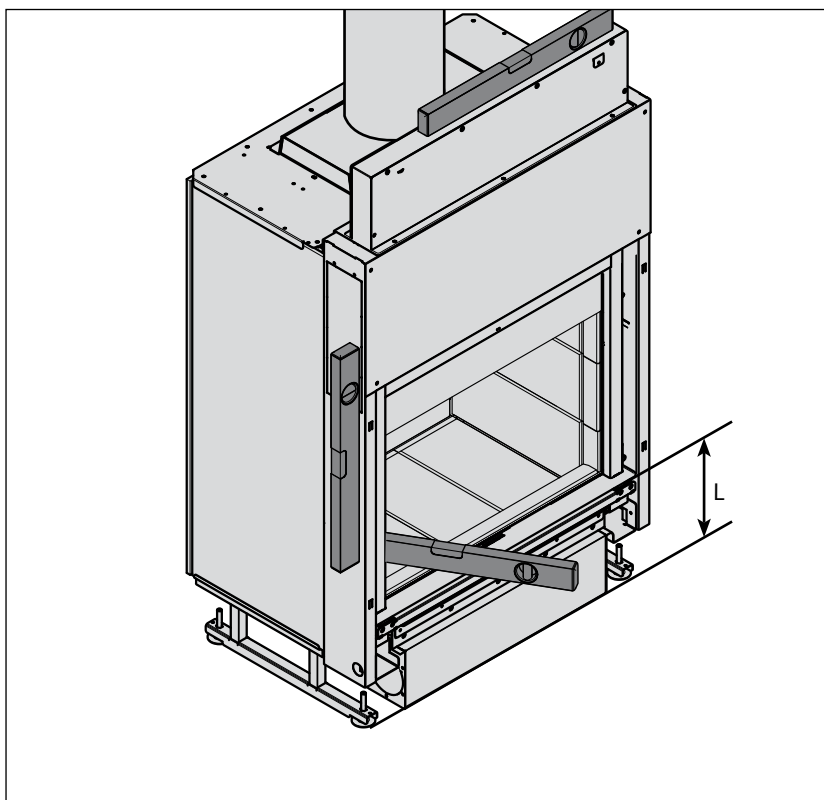

Before starting the installation, check that the stove is positioned at the correct distance from the partition, that the bottom rail of the door frame is at the correct height (see "L" in the "Dimensions" section) and that the stove is level.

ASSEMBLY OF A FAÇADE

How to position the stove when installing a façade

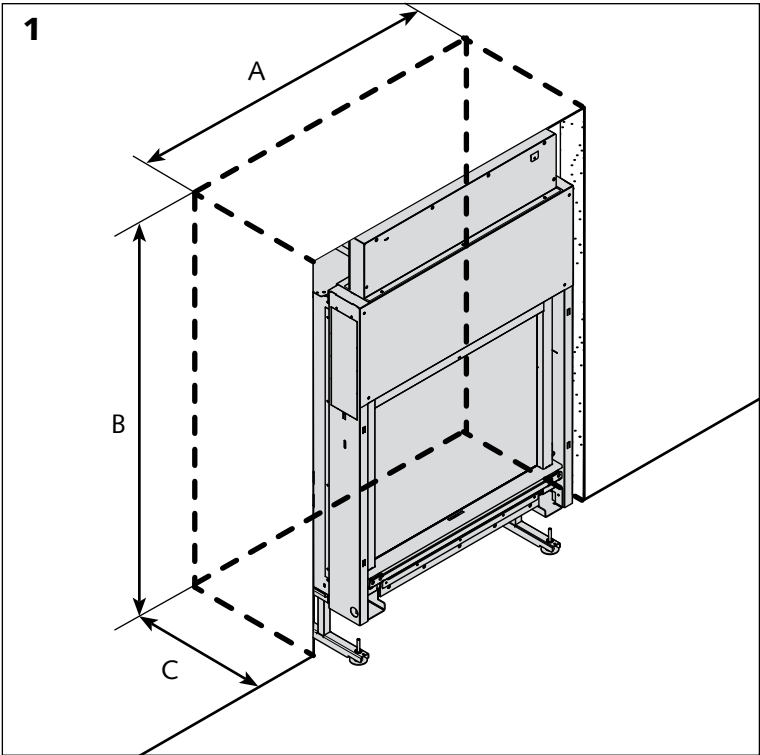

A (Max)
B (Max)
C (min)

| 21/75 | 21/85 | 21/95 | 21/105 |
|-------|-------|-------|--------|
| 920 | 1020 | 1120 | 1220 |
| 1380 | 1480 | 1600 | 1275 |
| 355 | 420 | 455 | 340 |

Screws needed

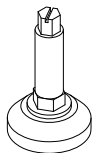

A
X 4 > SF
M10x40 bolt
52120002



B
X 16 > SF
Dome-headed Torx screw M6x12
52123009

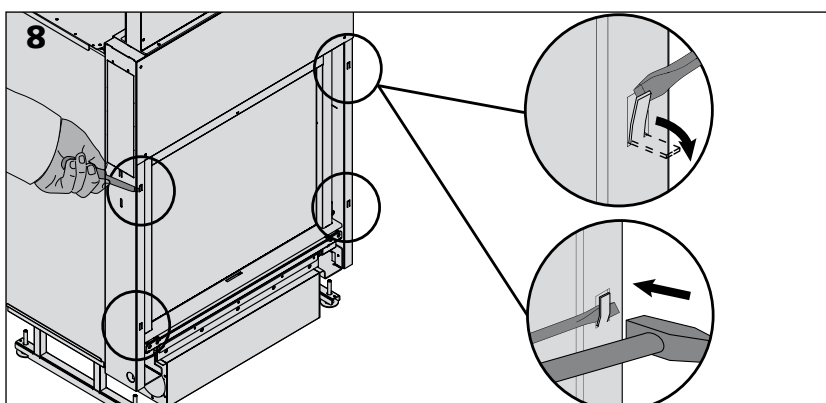
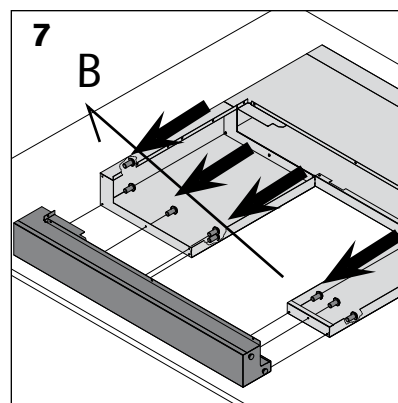
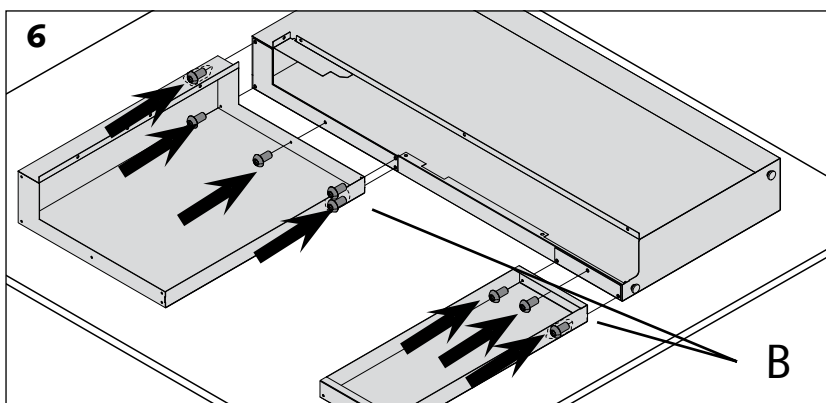
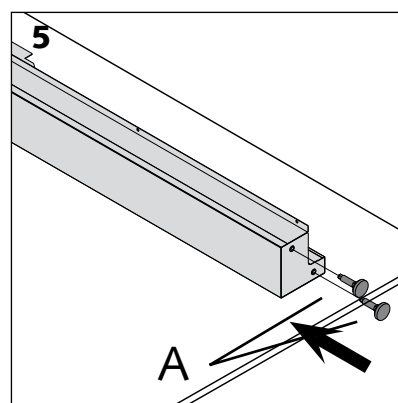
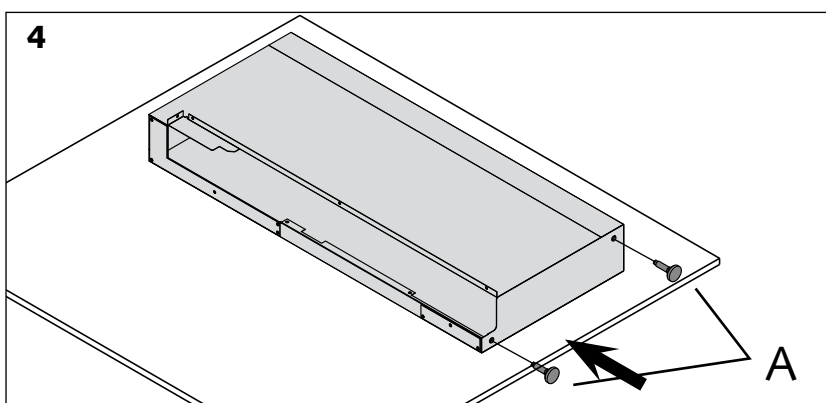
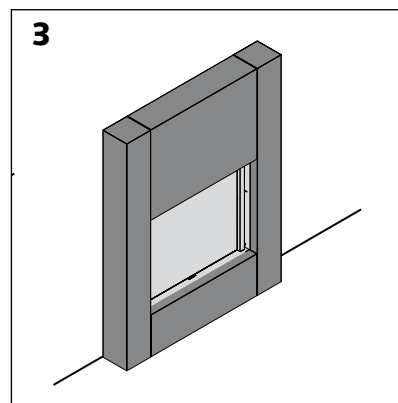
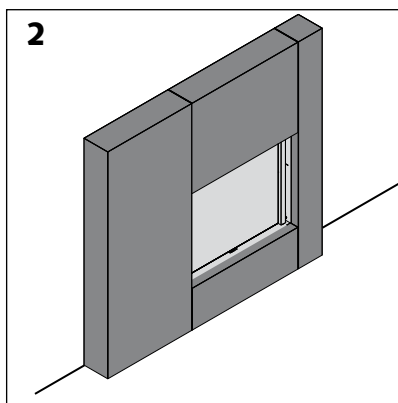
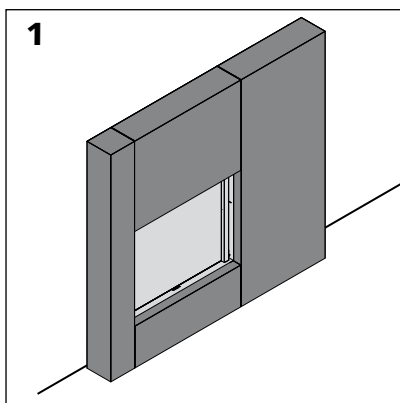

> Using a hammer and screwdriver, bend the 4 small lugs situated on the front of the product. The slots are for attaching the cladding to the stove.

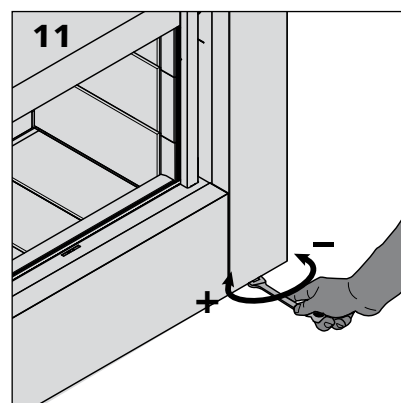
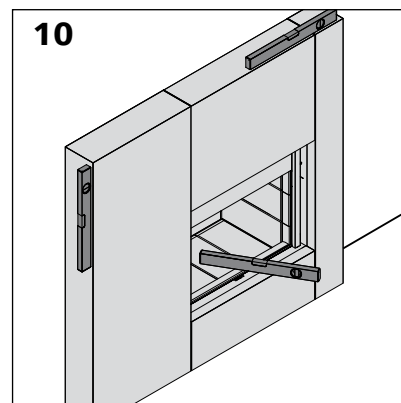
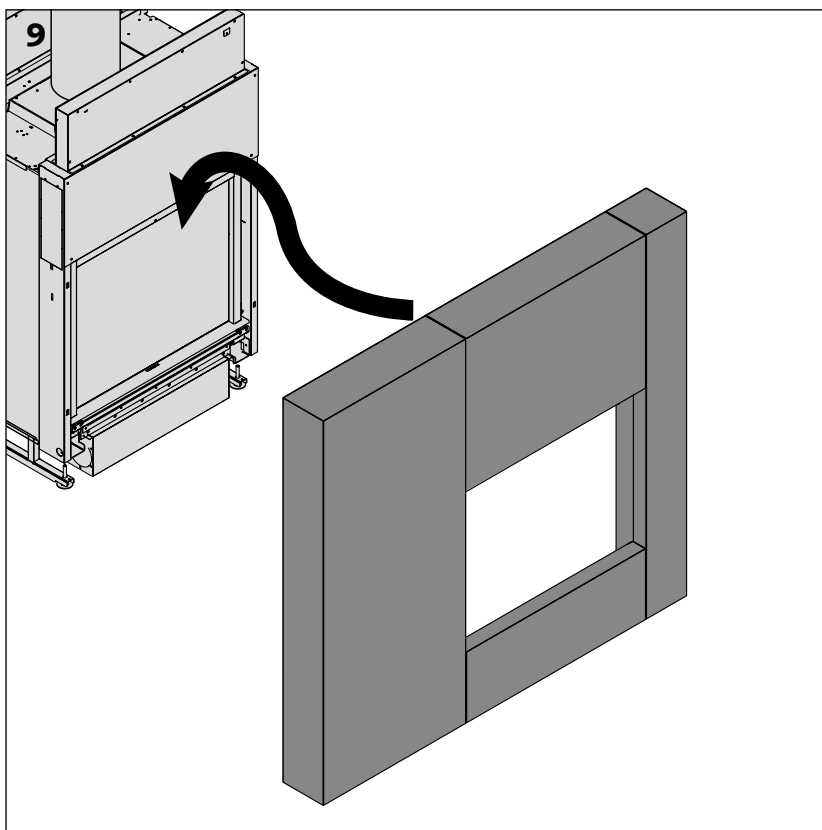

Take care always to leave at least 10 mm between the bottom of the cladding and the floor.

ASSEMBLY OF A READY-TO-FIT CHIMNEY

Stove front fasteners

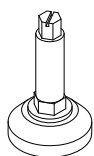

A
X 4 > SF
X 8 > DF
M10x40 bolt
52120002



B
X 16 > SF
X 32 > DF
Dome-headed Torx screw M6x12
52123009

Body section fasteners

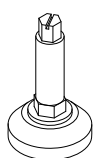

A
X 4
M10x40 bolt
52120002



C
X 12 > SF
X 24 > DF
Torx countersunk M6X16 screw
52124010



D
X 14 > SF
X 4 > DF
Dome-headed Torx screw M6x12
52123009



E
X 4 > SF
X 0 > DF
Torx countersunk M4X10 screw
52124002

How is the stove positioned when installing a ready-to-fit chimney SF ?

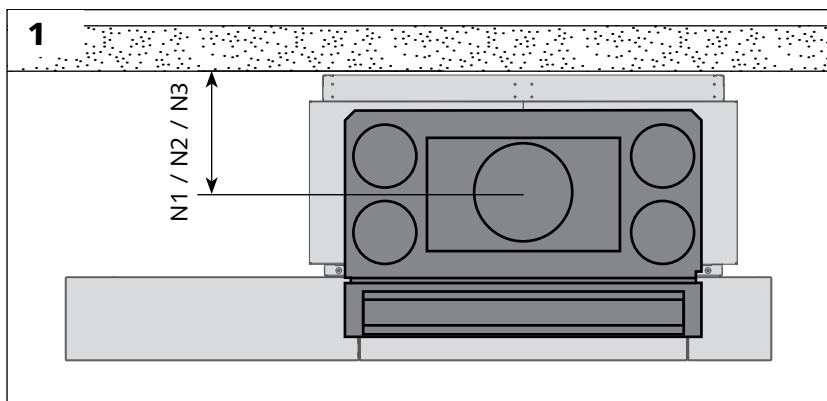

The rear corner of the cladding offers 3 different fixing depths.

Depending on your installation, the centre of the pipe must be 230, 260 or 280 mm from the partition.

These different distances allow the positioning of different thicknesses of insulation.

| | 21/75 | 21/85 | 21/95 | 21/105 |
|----|-------|-------|-------|--------|
| N1 | 367 | 432 | 467 | 352 |
| N2 | 397 | 462 | 497 | 382 |
| N3 | 417 | 482 | 517 | 402 |

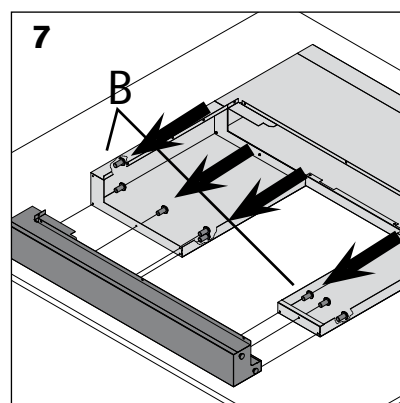
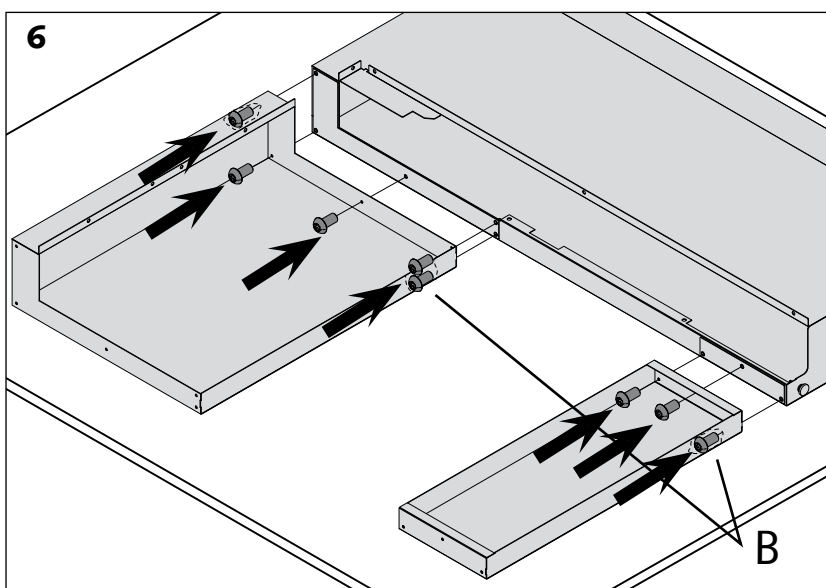
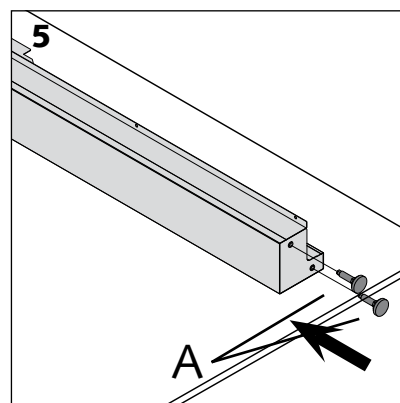
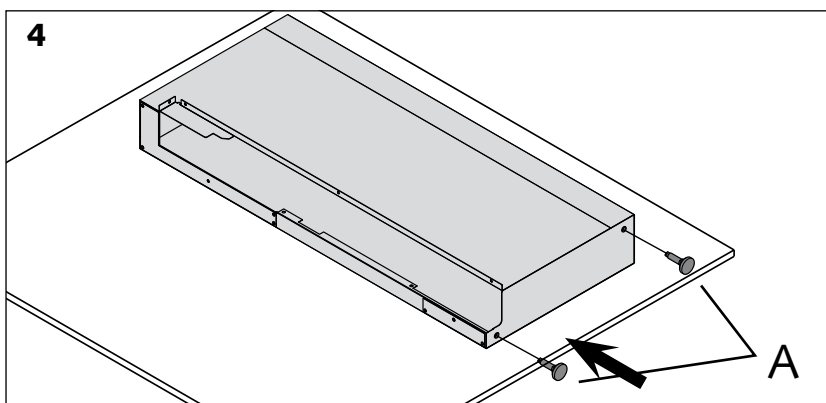
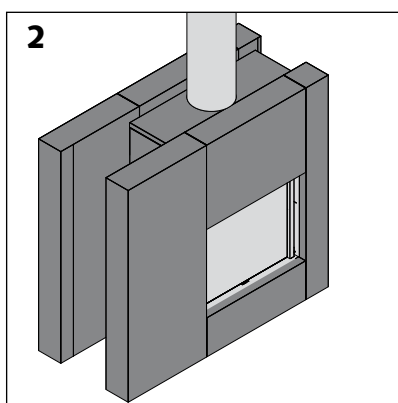
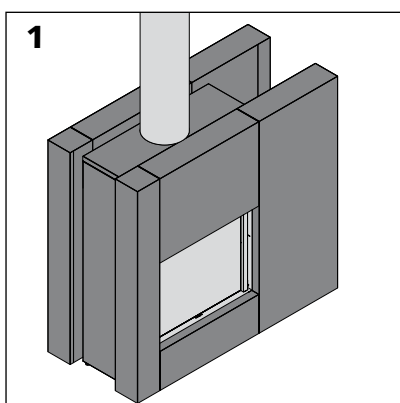
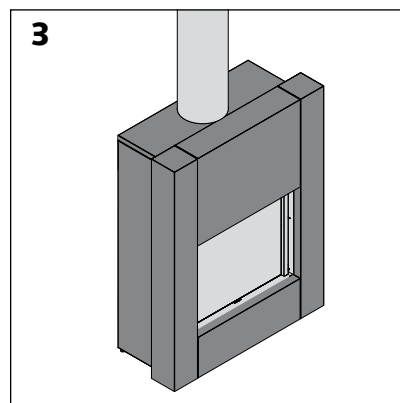
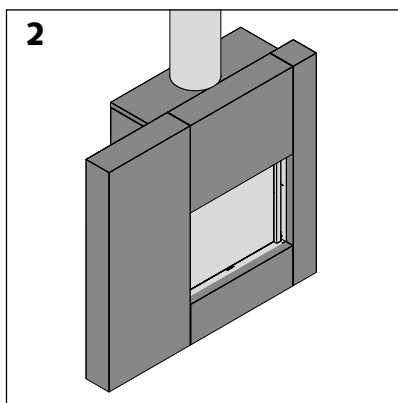
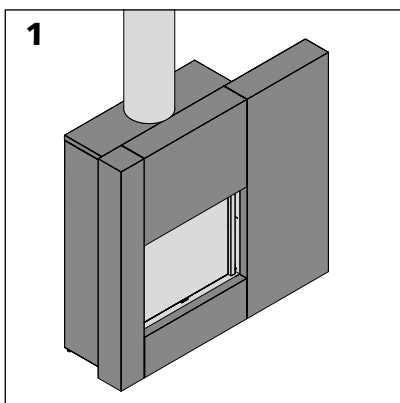

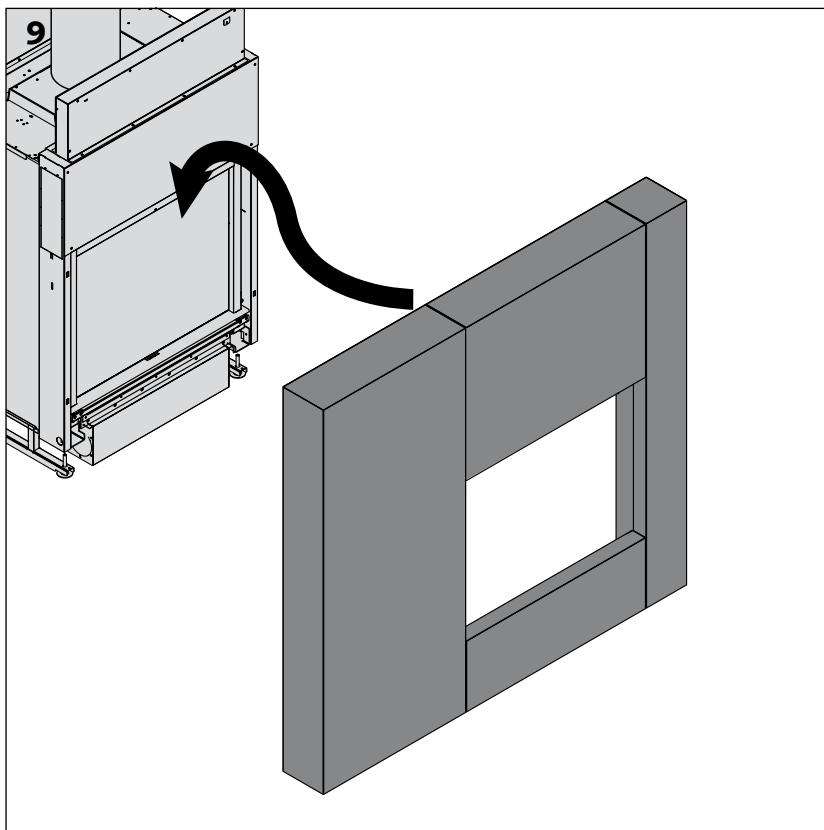
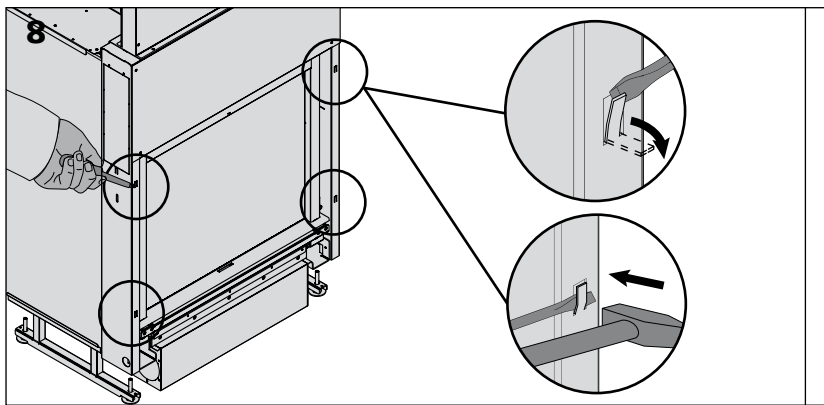

> After the front is placed on the stove, the next stages differ according to whether the cladding is single- or double-sided.

If you are installing single-sided Stûv cladding, carry on reading from the next page.

If you are installing double-sided Stûv cladding, carry on reading from page 16.

This page is only valid when installing a single-sided Stûv 21.

If you are installing a double-sided Stûv 21, go directly to page 16.

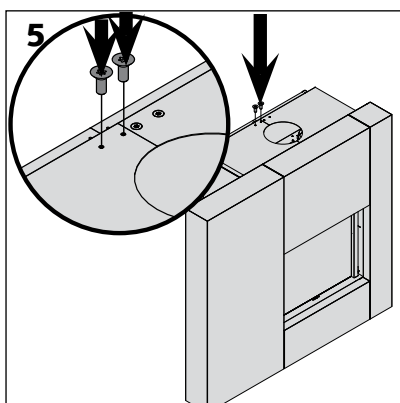
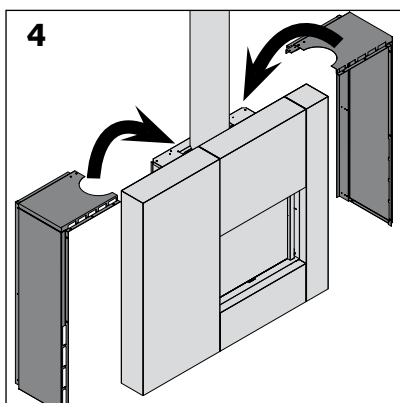
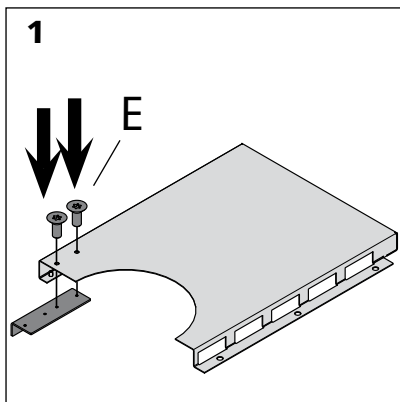

The L-shaped corner which is placed at the rear of the body section is optional. It can be installed in 3 different positions, corresponding to the various thicknesses of insulation [diagrams 2 & 3].

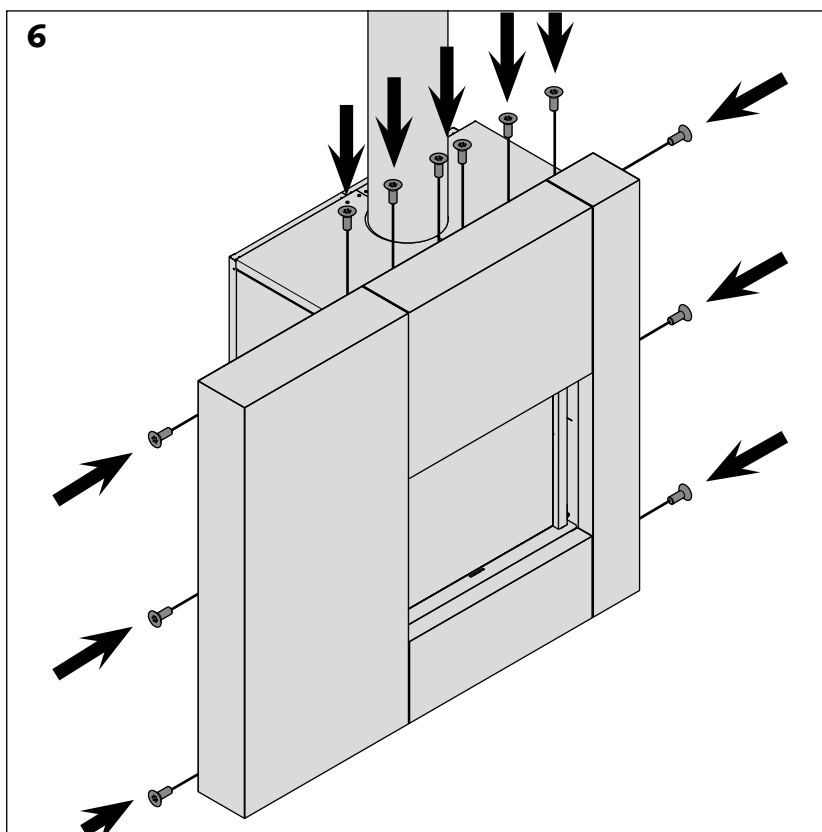
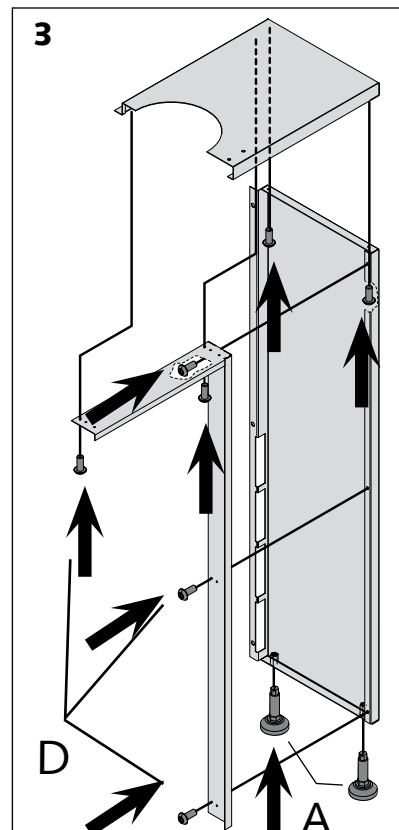
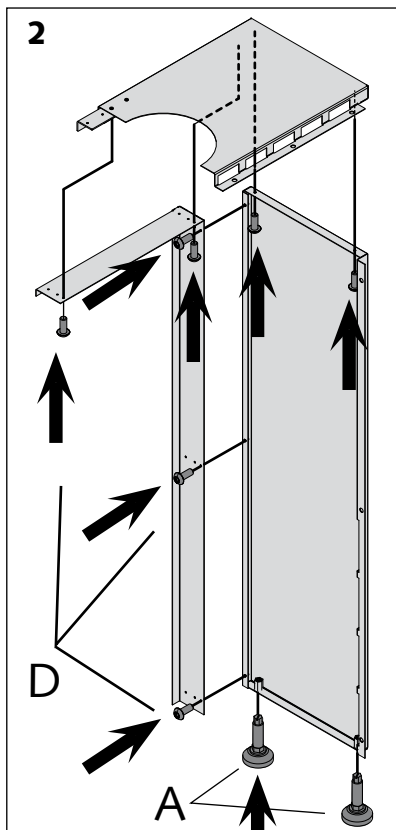

This page is only valid when installing a double-sided Stûv 21.

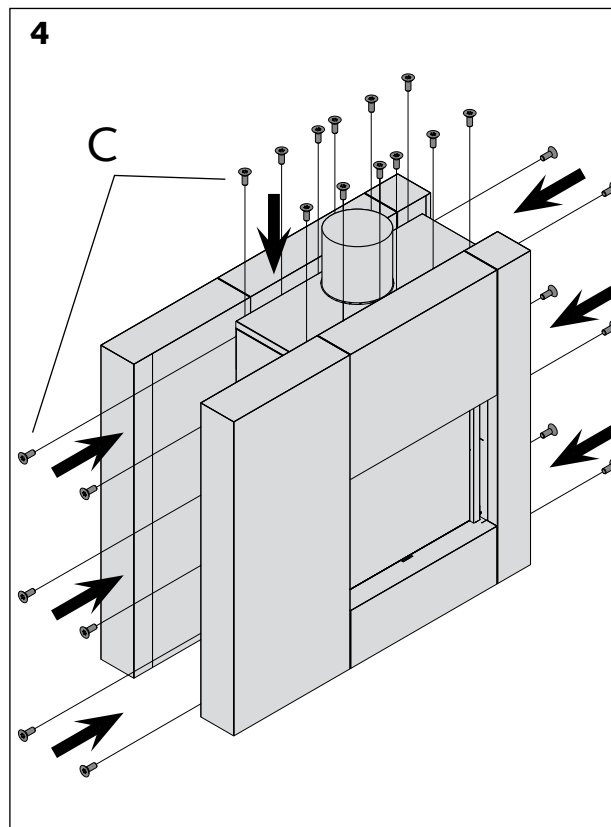
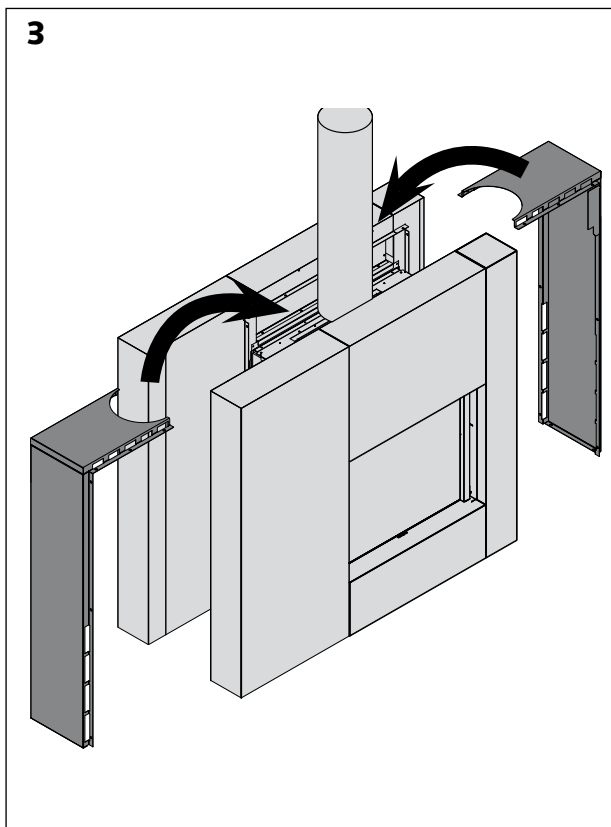
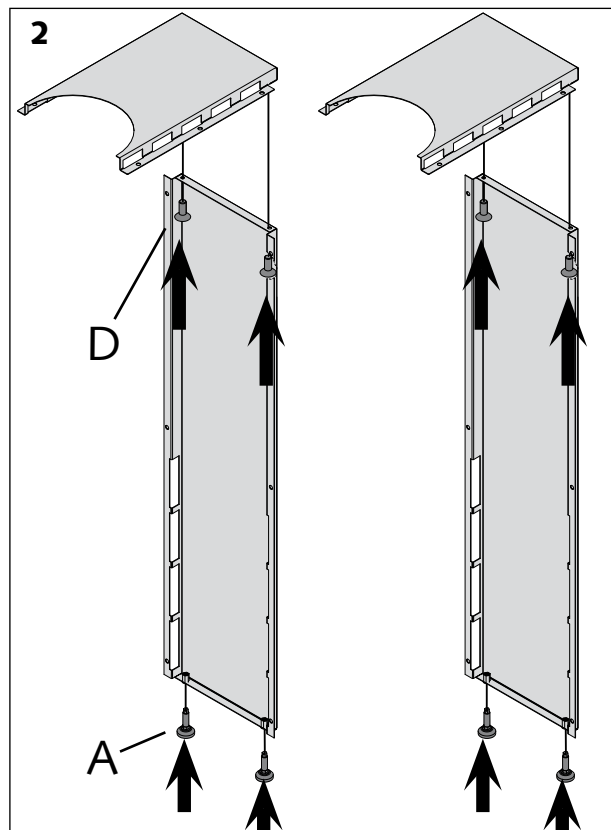
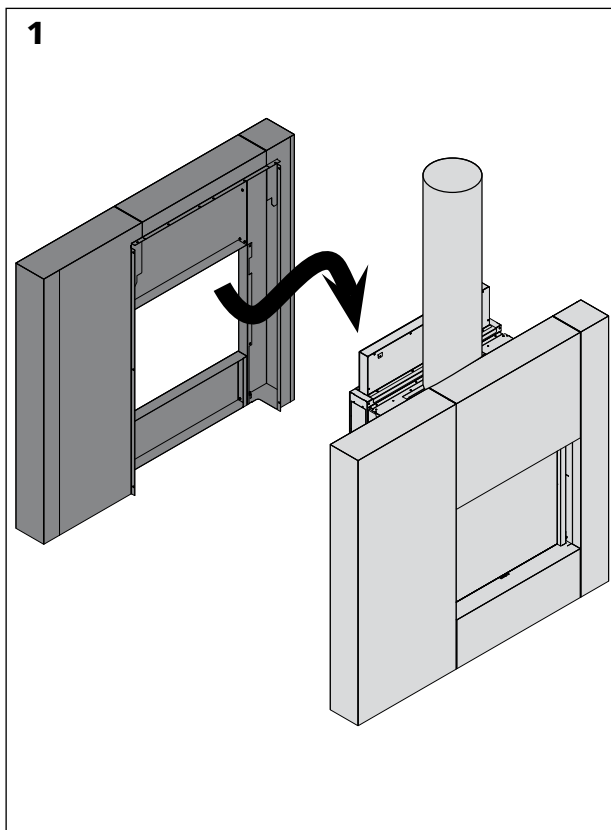

10

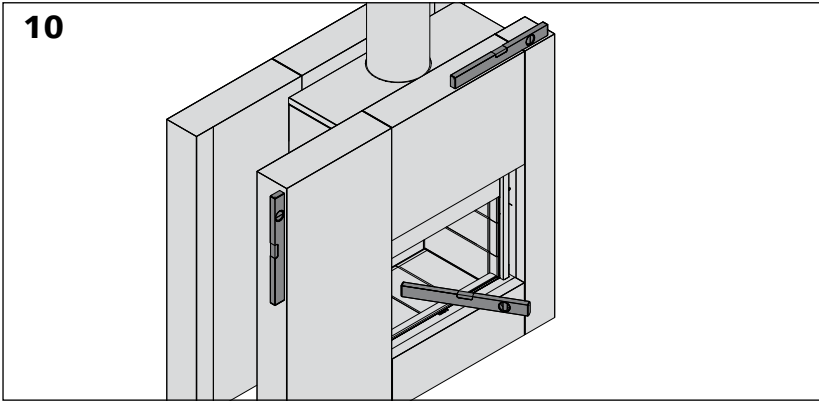

> Assemble the various components, using the 24 screws. Do not tighten the front screws before checking that the components are vertical.

> The cladding can be adjusted to the stove by means of the feet on the cladding and those on the stove.

11

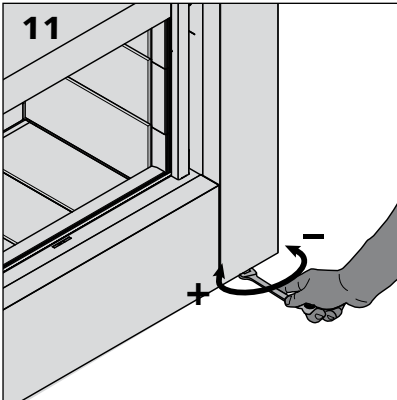

ASSEMBLY OF THE MOBILE LOG HOLDER

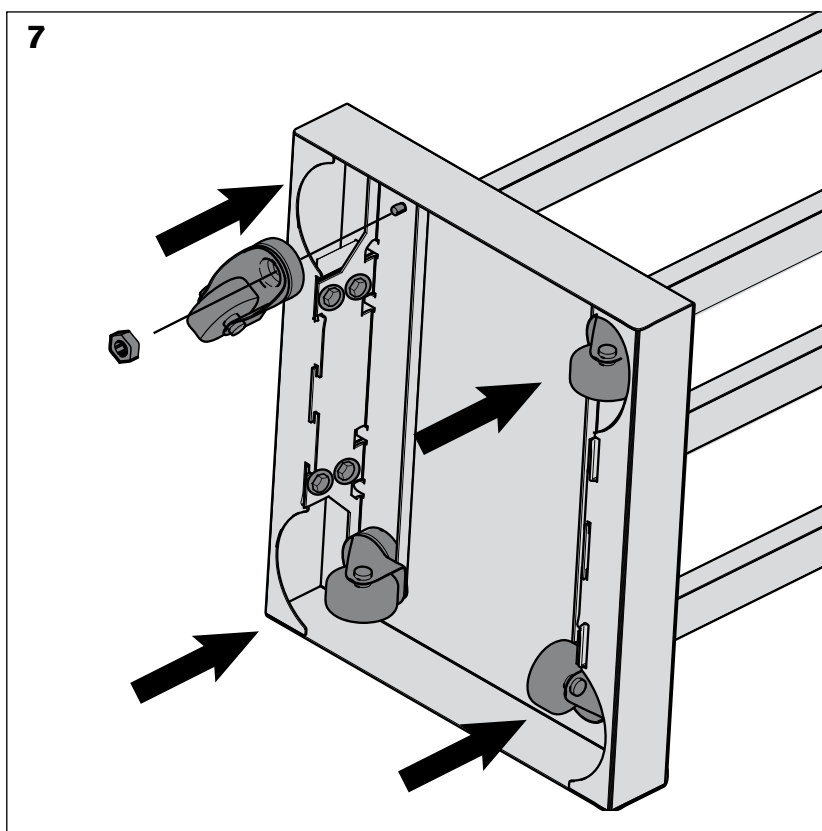
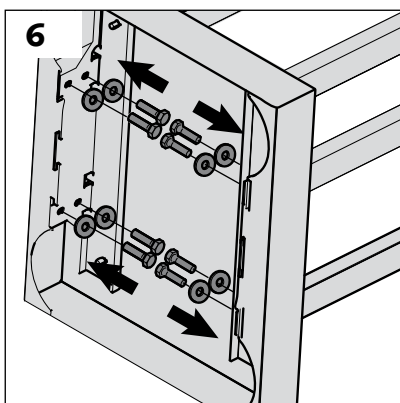
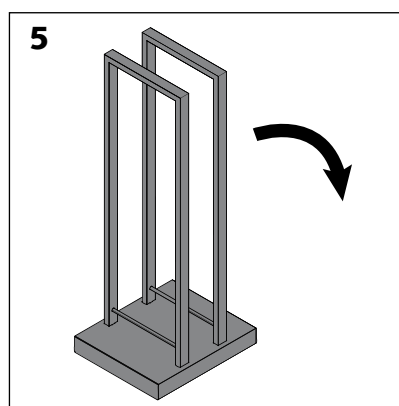
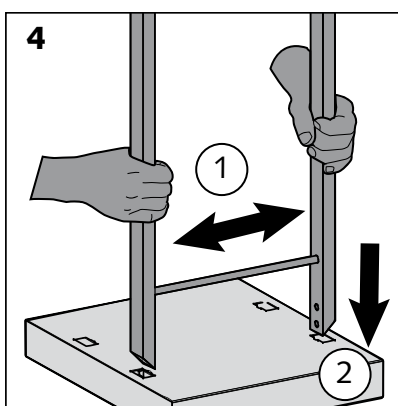
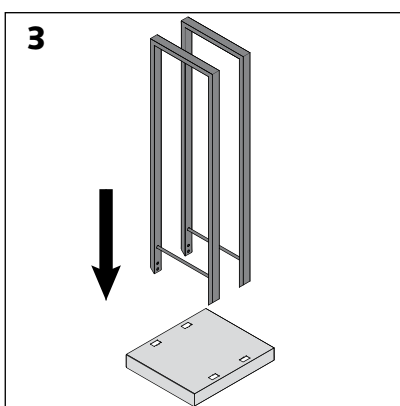
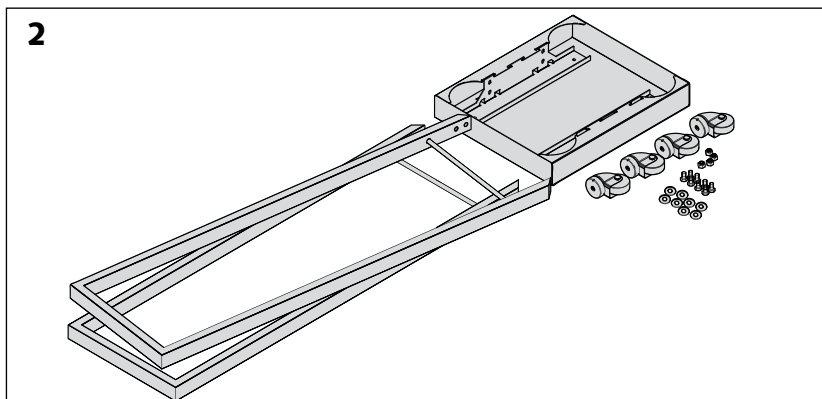
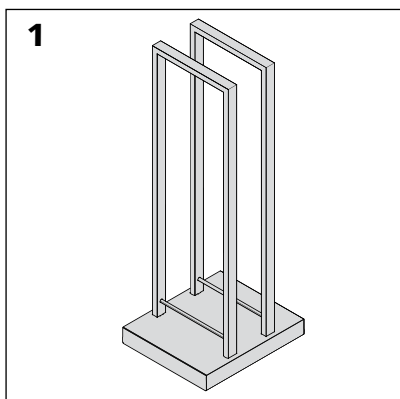

MAINTENANCE

Please note

Wait for the stove to cool down completely before carrying out maintenance.

Clean with a dry cloth.

Use a traditional, non-abrasive household detergent to clean the surfaces.

Never use solvents (acetone, white spirit).

Marks left by indelible markers cannot be removed.

If necessary, Stûv can provide a spray canister for touch-up work.

Please contact your dealer about this.

CONTACTS

Stûv stoves are designed and manufactured in Belgium by:

Stûv sa
rue Jules Borbouse 4
B-5170 Bois-de-Villers (Belgium)
info@stuv.com – www.stuv.com

Importer for the UK

Jet Master Fires Ltd – Unit 2
Peacock trading Estate, Goodwood Rd
SO50 4NT Eastleigh – Hampshire
T 0870 727 0105
jetmastersales@aol.com
www.jetmaster.co.uk

Importer for Finland

Ilkka Alatarvas OY
Pikkujärventie 4B
01680 Vantaa
T 400 872 858
www.takkamaailma.com

Importer for Sweden

Eldoform Sverige AB
Slipgatan 2 – 117 39 Stockholm
T 0707 883 53 – www.eldoform.se

Importer for Denmark

Stove APS
Aldershvilevej 84 – 2880 Bagsvaerd
T 51 33 10 93

Importer for Estonia

Tulering Kaminasalong Oü
Sopruse 145 – 13417 Tallinn
T +372 56 249 004 - www.tulering.ee



installation instructions [en]

Cladding for the Stûv 21(V2)

0414

Stûv reserves the right to make changes without prior notice.

These instructions have been produced with the greatest of care. However, we do not accept responsibility for any errors that may have been made.

Editor: Gérard Pitance – rue Jules Borbouse 4 – 5170 Bois-de-Villers – Belgium

[nl] [de] [it] [es] [pt] [cz] [en] [fr] >

This document is available in several languages:

Contact your distributor or visit www.stuv.com